

# Byron™ B306

## Wire Free Plug-through Chime Kit

1

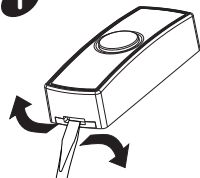

Using a small flat screwdriver, insert into the locking clip and gently twist. The back plate will unclip from the Bell Push.

2

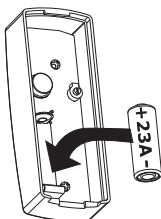

Insert the 23A battery (supplied) into the battery holder, making sure the Positive/Negative terminals match the internal markings. **Battery Comes Preinstalled**

3

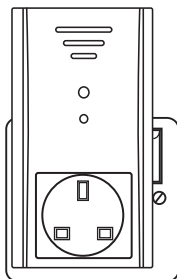

Insert the Plug-in Chime into a standard 220-240V ~50Hz wall socket and switch the socket ON, **Chime will ring.**

4

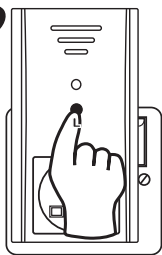

Press the learn button (L) on the front of the Chime to enter the Learn mode. **The chime will ring to confirm.**

5

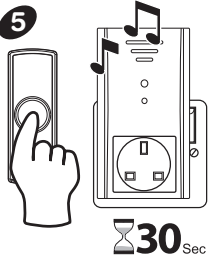

Press the Bell Push within 30 seconds, **the Chime will ring to confirm that the Bell Push has been paired to the Chime.**

6

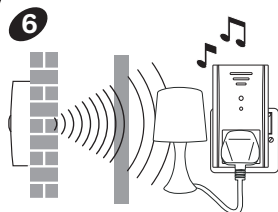

Test the Chime in the intended location, as internal walls and surfaces may reduce operating range. **DO NOT** mount onto metallic surfaces.

Plug in a standard plug e.g. Table light.  
**Max load: 1000W**

**Usage Guide:** Avoid positioning the Bell Push/Chime on or directly near metallic surfaces as this may reduce the operation range.



### UPVC Door Frames:

When positioning the bell push onto a UPVC door, always check the operating performance before final installation, internal metal frame of the door may affect performance.

**Tip:** Try adjusting the location of the Bell Push slightly to the Left/Right or place on external wall.

**Note:** the appliance is not to be used by children or persons with reduced physical, sensory or mental capabilities, or lack of experience and knowledge, unless they have been given supervision or instruction. Children should be supervised to ensure that they do not play with the appliance.

### Bell Push & Door Chime:

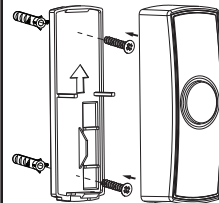

'CLICK'

- 1: Using back plate as template
- 2: Making sure UP arrow points UP.
- 3: Mark and drill holes.
- 4: Insert wall plugs and attach to wall using screws provided.
- 5: Clip the Bell Push on to the back plate making sure Bell Push 'Clicks' into place.
- 6: Place the Door Chime within the operating range (75M). Transmission of the wire free signal through Walls, Doors and Ceilings etc, may reduce the operating range. The Chime is designed for INDOOR use only.

### Melody Selection:

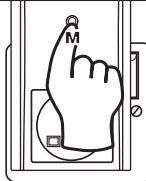

- To select a new melody for the Door Chime
- 1: Press the Melody Select button on the front of the Chime unit (M).
  - 2: The Chime will play the newly selected melody.
  - 3: Press again to select the next melody.

### Resetting Chime:

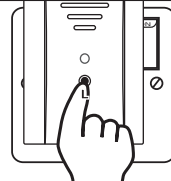

- To reset the chime and delete the bell push learnt to the chime
- 1: Press and hold the Learn button (L) until the Chime plays a melody - approximately 6 seconds.
  - 2: The Chime has been reset - see Points 4 & 5 to pair Bell Push

### Specification

Bell Push: DBT-SL  
Power: 1 x 23A 12V DC Battery (supplied)  
IP44 Weather Resistant

Plug-through Door Chime: DB306  
Power: 240 - 250V 50Hz  
Range: 50 Metres  
Max Load: 1000W  
Indoor Use Only



Project Manager: Mr G Hunter



**Tel: 0845 2301231(UK)**

9-5 Mon-Fri, Local call charges apply



support@chbyron.com

<http://www.chbyron.com>



CH Byron  
Byron House, Sherwood Rd  
Astonfields, Bromsgrove  
B60 3DR  
UK